



## Our hallmarks

- ✓ **One company, One activity:**  
Pure player of Interoperability.
- ✓ **OEM customers focused:**  
Co-building of your customized solution.
- ✓ **Actively involved in standardization,**  
particularly the **STEP AP242** standard.
- ✓ **Prompt and proactive support** or customers' projects: committed R&D and technical support staff.
- ✓ **Long-term partner of the software editors:**  
technologically, organisationally and economically independent.



# datakit

## SDK for CMN, QUALITY, CAM APPLICATIONS DEVELOPERS

Geometry / Features / Representation /  
PMI / FD&T / Metadata / Properties



© Datakit : all the products names mentioned are trademarks of their respective holders.

CATIA / CREO / INVENTOR  
NX / RHINO / SOLIDEDGE  
SOLIDWORKS / ACIS  
PARASOLID / CGR / DXF  
IGES / STEP / JT / PDF  
FUSION / ...

90 avenue Félix Faure  
69003 Lyon - FRANCE  
[sdk@datakit.com](mailto:sdk@datakit.com)

[www.datakit.com](http://www.datakit.com)

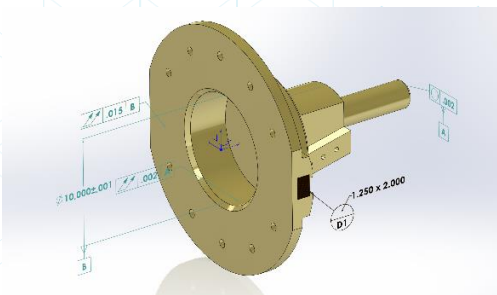

## Native or neutral semantic or graphic data retrieval

- ✓ 2D drawing, 3D B-rep, and representation,
- ✓ Holes design numerical values: positioning, sketch, depths, diameters, angles, direction,
- ✓ Semantic data of holes types (*simple, tapered, counter bored, sunk, drilled, etc*), tolerancing, pitch and thread information,
- ✓ Links to sketch, support and generated geometries,
- ✓ Pattern / toolpath information: rectangular, circular, user-defined instances ...

## Tailor-made approach

- ✓ **Optimum results:**  
Toolkit to extract information software vendors need for Control, Measurement, CAM or Inspection purposes.
- ✓ **Single structured API:**  
Homogeneous integration environment.
- ✓ **Regularly updated solutions:**  
New versions available every quarter.
- ✓ **Comprehensive API guide:**  
Smooth integration and upgrade.
- ✓ **Scalable solutions that evolve in line** with the technical and business development of customers' applications.
- ✓ **Responsive R&D & support teams:**  
Tailored service from integration to solution delivery.

## Integrate our solutions

CrossCAD/Ware

**File to File**

Converts dozens of formats to the one your application processes.

CrossCAD/Ware

**SDK**

Allows the extraction and output of 2D & 3D technical formats, embedded in your applications.

## Support of PMI Product Manufacturing Information

- ✓ Datums, targets, references,
- ✓ Dimensions: linear, angular, radial ...,
- ✓ Geometrical tolerances: flatness, cylindricity, surface profile, position, angularity ...,
- ✓ Roughness and welding.

## LONG TERM PARTNER of software editors and application developers

+  
30 years' of experience

+  
Pioneer in 2D & 3D interoperability

+  
Confidentiality respect

+  
Customers all over the world

+  
Additional range of solutions for design offices

NOTES (UNLESS OTHERWISE SPECIFIED):

1. OBTAIN DIMENSIONS FOR ALL UNDIMENSIONED FEATURES FROM THE MODEL. ALL DIMENSIONS OBTAINED FROM THE MODEL ARE BASIC UNLESS OTHERWISE SPECIFIED.
2. ASME Y14.1-11-2003 APPLIES TO DATASET.
3. ASME Y14.5M-1994 APPLIES TO DIMENSIONING AND TOLERANCING.

